

How to...

Replace Reformer Front End

Step 1

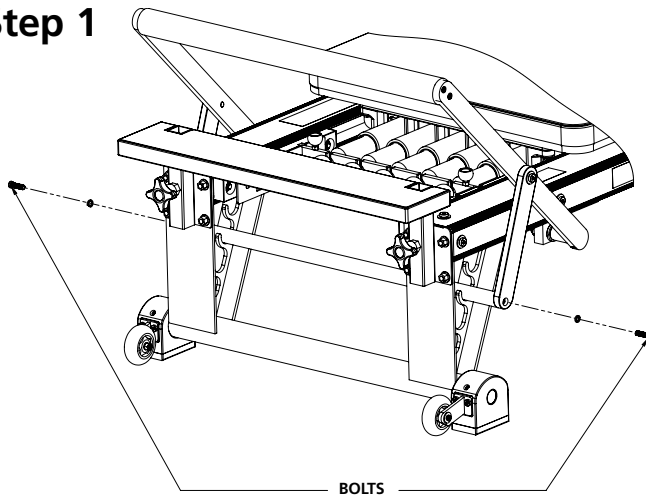

Disassembling

1. Remove bolts on swing arm support with $\frac{1}{4}$ " hex key (supplied).
2. Remove the swing arm support.
3. Remove the socket head bolts from the footbar. Remove the hex lock nuts.

Step 2

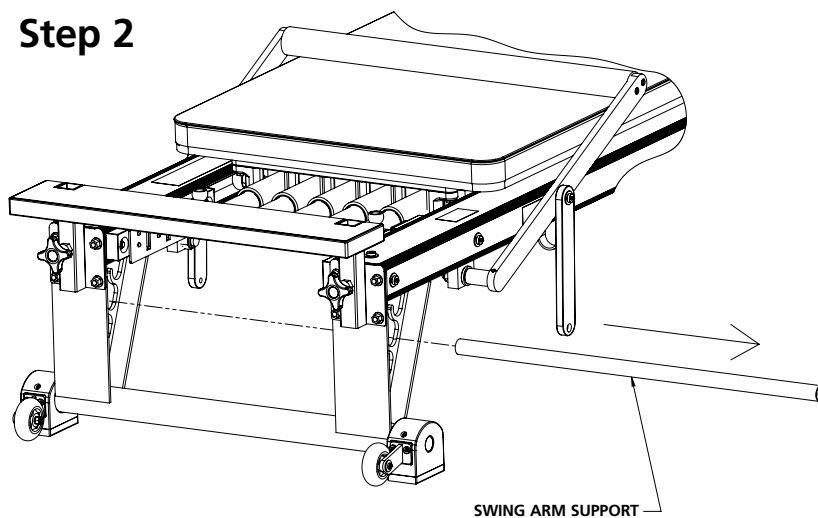

Step 3

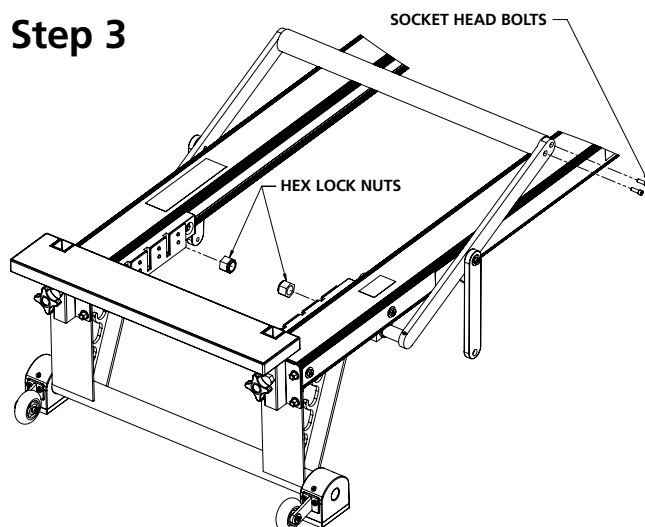

Step 4

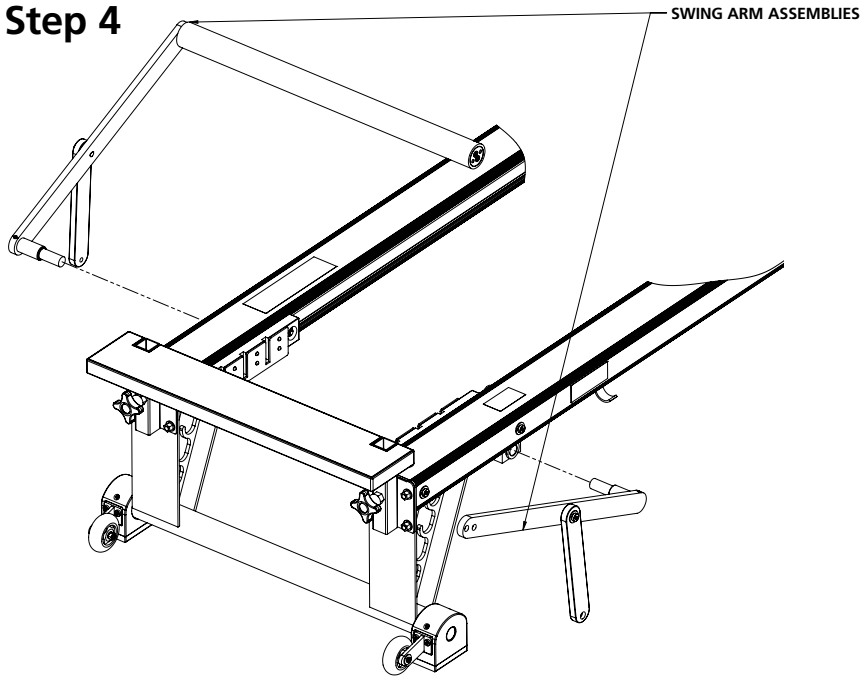

Disassembling

4. Remove the two (2) bolts from the top rails with 3/16" hex key (supplied).
5. Once all the bolts have been removed, slide and remove the front end assembly.

Step 5

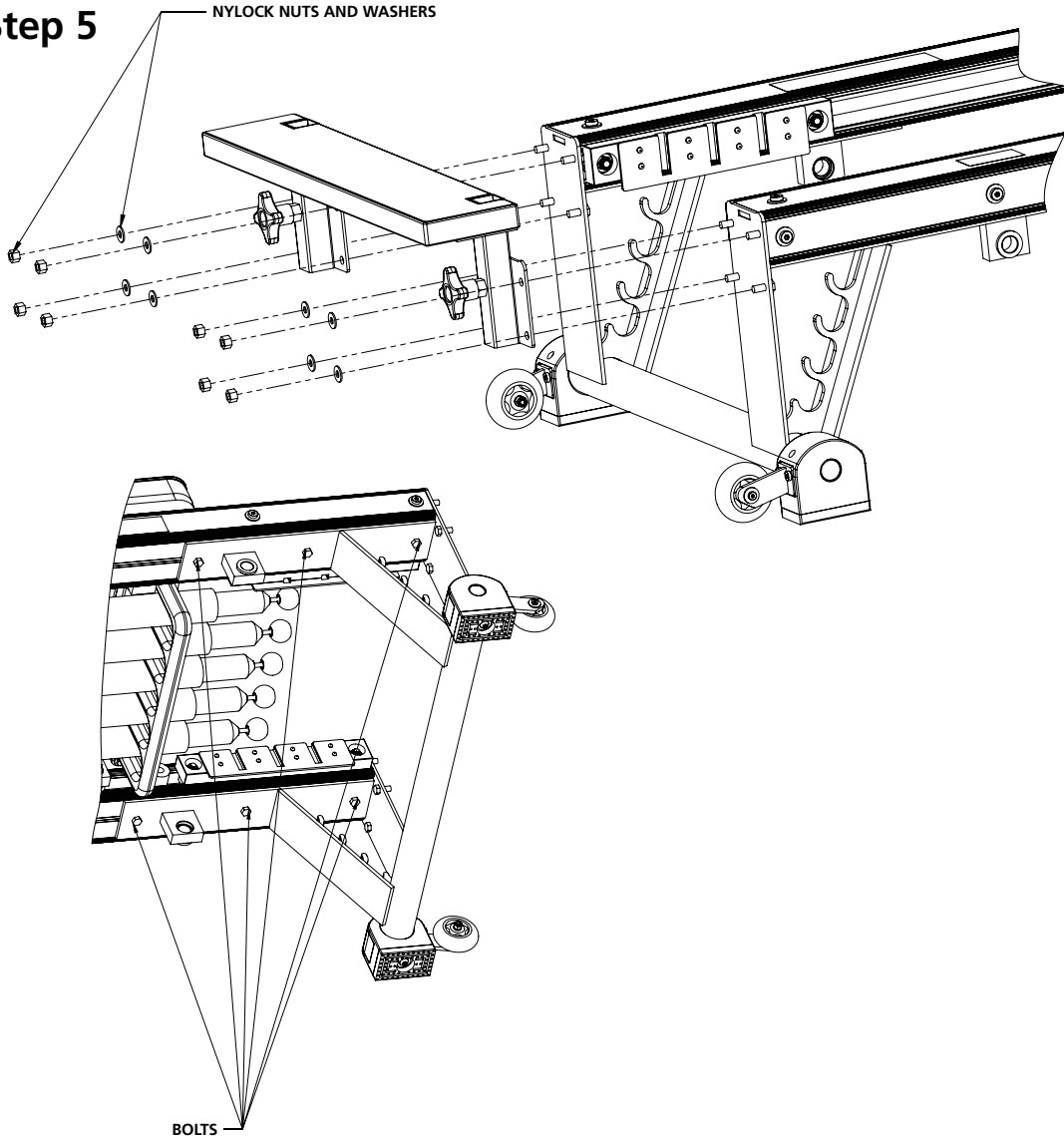

Step 1

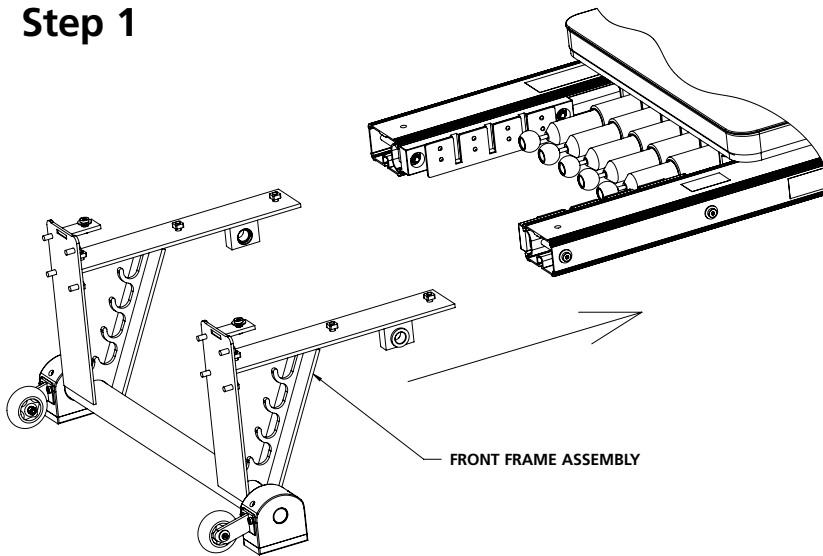

Assembling

1. Slide and insert new front end assembly.
2. Insert two (2) bolts and tighten with a 3/16" hex key (supplied).
3. Tighten the four (4) bolts under the aluminum rails with a 9/16" x 1/2" wrench (supplied).

Step 2

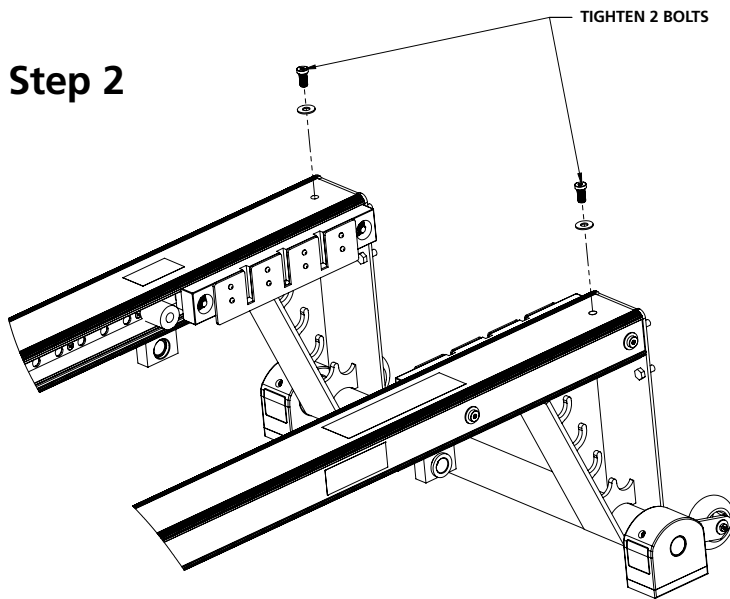

Step 3

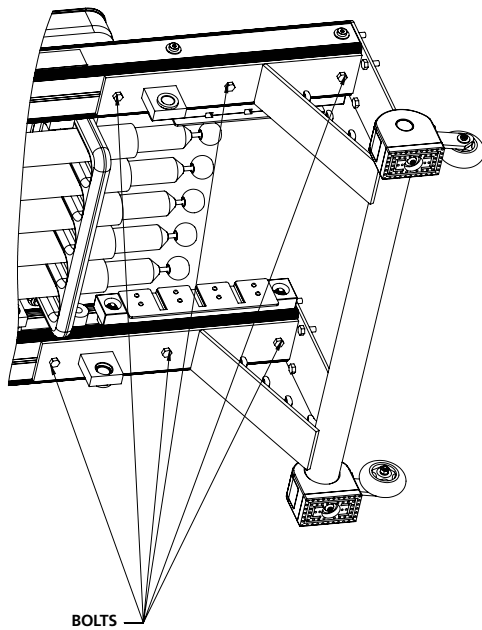

Step 4

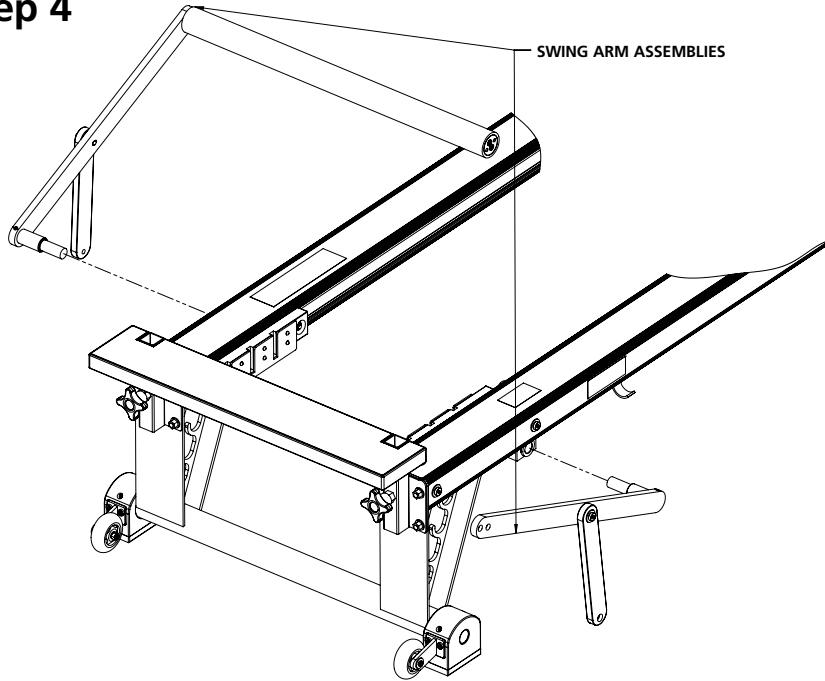

Assembling

4. Inset the swing arm support.
5. Insert the two (2) bolts into the swing arm support and tighten with $\frac{1}{4}$ " hex key (supplied).

Step 5

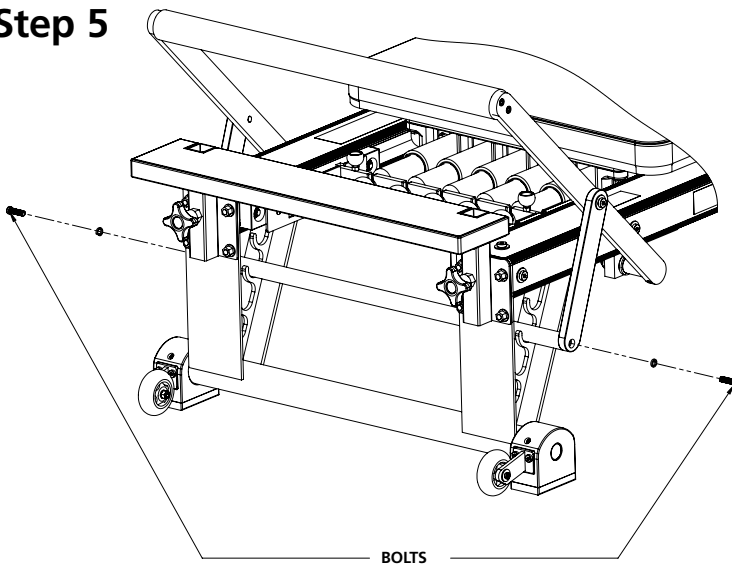

For more information contact our Customer Service

1.800.910.0001 ext. 288 | 0800.328.5676 ext. 288 (UK) | 416.482.4050 ext. 288 (Customer Care)
customerservice@merrithew.com | merrithew.com